

# 2017 ACG LA DEAL SOURCE

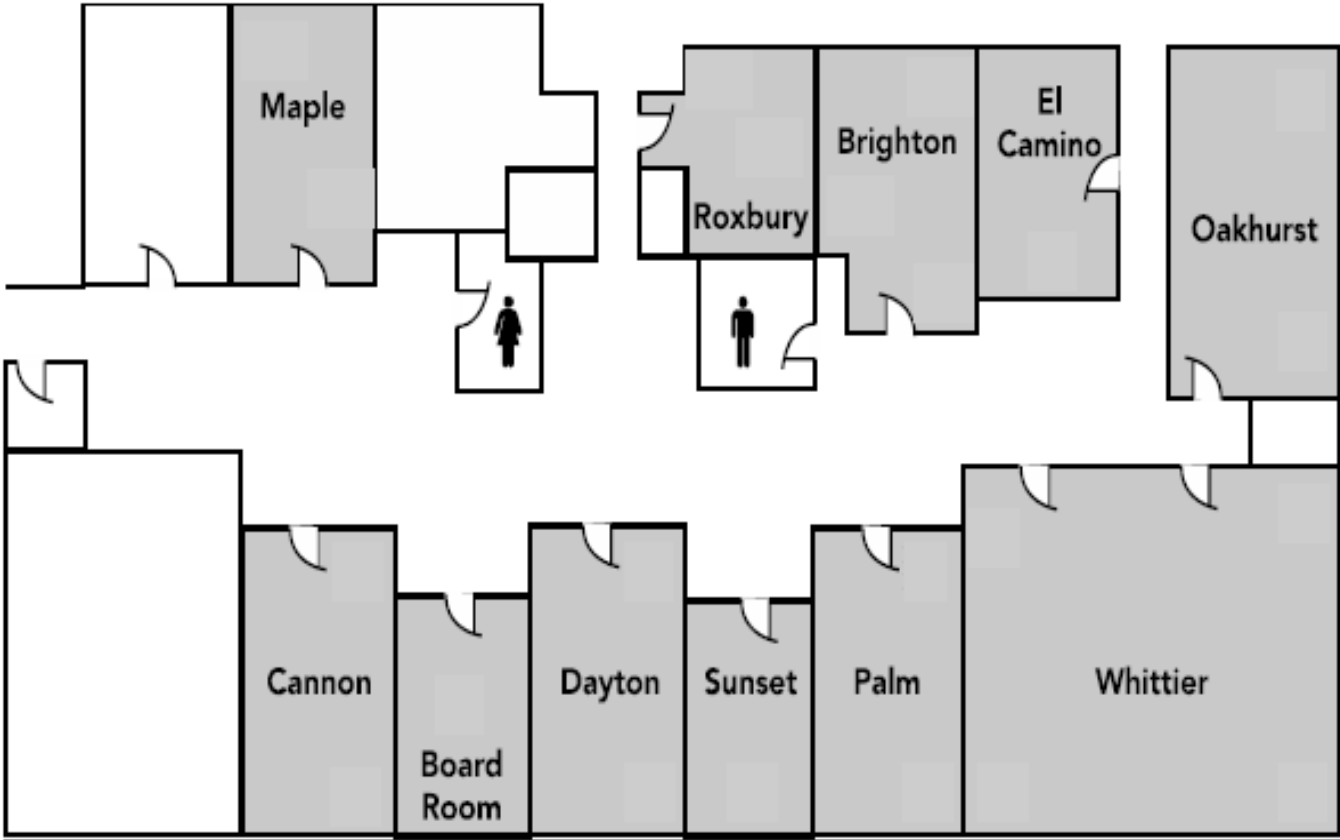

EXECUTIVE MEETING ROOMS

SPONSORED BY

VedderPrice

<b>INVESTMENT BANK</b>	<b>ROOM</b>
<b>Alantra</b>	<b>Maple</b>
<b>Bainbridge</b>	<b>Maple</b>
<b>Baird</b>	<b>Maple</b>
<b>BDO USA, LLP</b>	<b>Maple</b>
<b>Bowen Advisors</b>	<b>Cannon</b>
<b>Cabrillo Advisors</b>	<b>Cannon</b>
<b>CenterPoint M&amp;A Advisors</b>	<b>Cannon</b>
<b>Clear Capital Advisors</b>	<b>Cannon</b>
<b>CriticalPoint Partners</b>	<b>Roxbury</b>
<b>D.A. Davidson</b>	<b>Roxbury</b>
<b>Dinan &amp; Company, LLC</b>	<b>Roxbury</b>
<b>Duff &amp; Phelps</b>	<b>Dayton</b>
<b>EA Markets LLC</b>	<b>Dayton</b>
<b>Fidus Partners</b>	<b>Dayton</b>
<b>FocalPoint Partners LLC</b>	<b>Dayton</b>
<b>Focus Investment Banking</b>	<b>Dayton</b>
<b>G2 Capital Advisors LLC</b>	<b>Sunset</b>
<b>GCA Advisors, LLC</b>	<b>Sunset</b>
<b>Generational Equity, LLC</b>	<b>Sunset</b>
<b>Genz &amp; Associates LLC</b>	<b>Sunset</b>
<b>Greif &amp; Co.</b>	<b>Palm</b>
<b>Harris Williams &amp; Co.</b>	<b>Palm</b>
<b>Harvey &amp; Company LLC</b>	<b>Palm</b>
<b>Headwaters MB</b>	<b>Palm</b>
<b>Houlihan Lokey</b>	<b>Palm</b>

<b>INVESTMENT BANK</b>	<b>ROOM</b>
<b>Imperial Capital</b>	<b>Brighton</b>
<b>Intrepid Investment Bankers, LLC</b>	<b>Brighton</b>
<b>KPMG Corporate Finance LLC</b>	<b>Brighton</b>
<b>Lazard Middle Market LLC</b>	<b>Brighton</b>
<b>Livingstone Partners</b>	<b>Brighton</b>
<b>MHT Partners</b>	<b>El Camino</b>
<b>NMS Capital Group</b>	<b>El Camino</b>
<b>NTA</b>	<b>El Camino</b>
<b>Objective Capital Partners, LLC</b>	<b>El Camino</b>
<b>Piper Jaffray</b>	<b>Whittier</b>
<b>Provident Healthcare Partners, LLC</b>	<b>Whittier</b>
<b>Qualia Legacy Advisors</b>	<b>Whittier</b>
<b>Raymond James &amp; Associates, Inc.</b>	<b>Whittier</b>
<b>RBC Mid Market M&amp;A</b>	<b>Whittier</b>
<b>Reynolds Advisory Partners</b>	<b>Whittier</b>
<b>Richard Vander Kaay &amp; Associates, Inc.</b>	<b>Whittier</b>
<b>Riverbrook Capital</b>	<b>Whittier</b>
<b>Signal Hill</b>	<b>Whittier</b>
<b>SLATE Partners</b>	<b>Whittier</b>
<b>Stephens Inc.</b>	<b>Oakhurst</b>
<b>Stout Advisory</b>	<b>Oakhurst</b>
<b>The Sage Group</b>	<b>Oakhurst</b>
<b>Valufinder Group</b>	<b>Oakhurst</b>
<b>White Ridge Capital</b>	<b>Oakhurst</b>
<b>Wunderlich Securities</b>	<b>Oakhurst</b>